

Airsafe

■ EOL-TE-LED (E TEL)

■ LED Elevated Taxiway Edge Light



Compliance with Standards

CAAC:AC-137-CA-2015-01 & 03
 SAC: GB/T 7256
 ICAO: Annex 14, Volume I
 IEC: TS 61827
 FAA: AC 150/5345-46 & EB NO.67
 NATO: STANAG 3316

Application/Use

Taxiway edge light

Features

- LED is featured by long life, effective energy saving, maintenance-free, which brings enormous economic benefits to customer
- Patent inverted-cone prism with high light utilization ratio
- Precise beam angle range from zero to six degrees, which won't dazzle the pilots at close range
- Consistent dimming curve with halogen lamp fixture, complying with FAA standards
- Strict LED color management to ensure premium color consistency
- Prism made of glass material, of which the surface is resistant to the sand erosion
- Distinctive inverted-cone edge of prism, which effectively prevent accumulation of rain and snow, wind and sand
- Proprietary driving circuit and thermal management solution, which greatly improves the reliability and service life of light fixture
- Power factor above 0.9, which minimizes the power network interference
- Optional function of single lamp failure detection, which enables the light to be open as halogen lamp once LED fails
- Tool free maintenance, easy disassembly, single hand lamp replacement possibility
- The main body is made of aluminum alloy with anti-corrosion surface treatment, all fasteners are made of stainless steel, suitable for various harsh environment applications
- High-precision parts and components machining to ensure all dimensional quality and accuracy
- Forged frangible pole with precise machining, complying with FAA standards, ensuring good stability and reliability
- IP66-grade ingress protection of the fixture, keep interior from dust
- Level gauge can be placed directly on the top of prism to adjust the horizontal angle of lighting fixture

Ordering Information

EOL-TE-LED-XXX-B-X

Type _____
 EOL-TE=Elevated taxiway edge light

Light Source _____
 LED=LED lamp

Power Supply _____
 220 = 220VAC
 024 = 24VAC
 012 = 12VAC
 066 = 6.6A

Beam Color _____
 B=Blue

Optional Function _____
 M=single lamp fault detection function

* Please provide detailed installation info while ordering, spare parts and accessories should be separately ordered with specific order no.

EOL-TE-LED

1
2

Installation

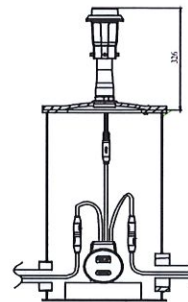

Fig 1. On 12" deep base.

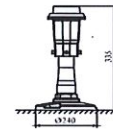

Fig 2. Flange direct mount

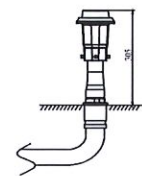
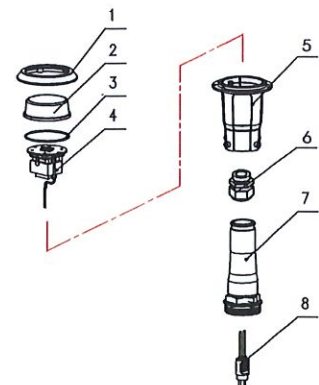

Fig 3. Stake mount

* Please find detailed information in installation manual

Structure

1. Upper cover
2. Prism
3. Light body gasket
4. Photoelectric assy
5. Light body
6. Waterproof gland
7. Frangible pole
8. plug



Airsafe

■ EOL-TE-LED (ETEL)

■ LED Elevated Taxiway Edge Light

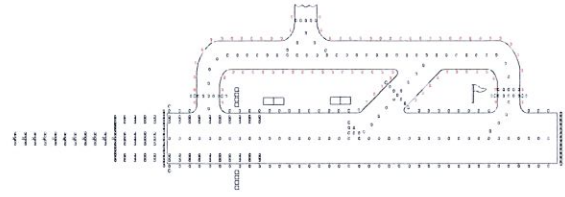

Specifications

Light source: one Blue LED particle
 Power : 4 VA
 Power Factor: ≥ 0.9
 IP Grade: IP 66

Photometric Data

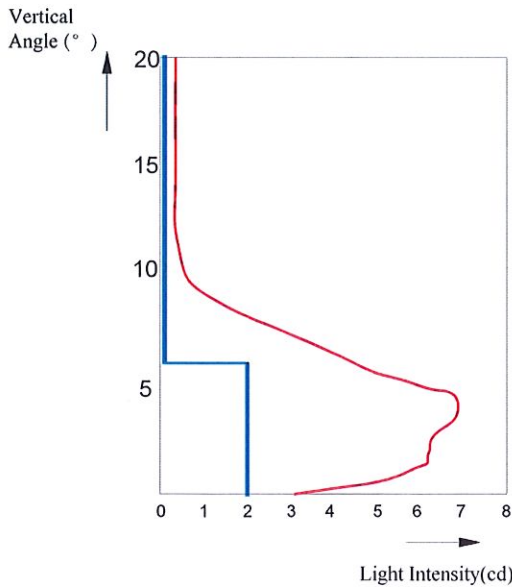

EOL-OB-LED (Red), ICAO Table 6.3 Type B, FAA L-810

Application		Main Beam		Color	Required min. cd	Actual min. cd
		H	V			
EOL-TE-LED	ICAO 5.3.17.8	360°	0°-6°	Blue	2	2.3
			6°-75°			
	FAA L-861T	360°	1°-6°		2	2.5

Packing Data

4 elevated lights Size: 300×255×380 mm³
 Unit net weight: 1.28 kg Gross weight: 5.5 kg

Spare Parts

Struc No.	Part Name	Order No.	Description
1	front cover	44515-B	front cover-blue
2	Prism	931116	Inverted-cone prism III
3	Light body gasket	41114	o-ring gasket 71*2.65
4	photoelectric assy	44512	photoelectric assy (taxiway edge light)
5	waterproof gland	M20*1.5-2*5	waterproof gland M20*1.5-2*5
6	light body	44516-B	light body (V) blue
7	frangible pole	24211	frangible pole-04
8	plug	70603	secondary cable plug- Style 6

Accessories

Description	Order No.
flange 240mm	276A1
flange 304mm (FAA standard)	27683
hex wrench for frangible pole of elevated lights	54101
calibrator assy	954211
secondary cable receptacle - style 7	70703
15-watt isolation transformer	ITF-015-066
isolation transformer housing	TJB-12

* All rights reserved, subject to modifications



E C A

CERTIFICATE OF CONFORMITY

08/X29/1/6346743-1001-11, rev.1

TO:
ICAO, Annex 14, Volume I, 7th Edition
UNE-IEC/TS 61827, 1th Edition
FAA AC 150/5345-46E
FAA EB 67D
AENA PPT 017 -04/12

Products: Airfield Lighting Lights EOL-XX-LED
Manufactured by: Airsafe Airport Equipment Co., Ltd
Applications:
LED Elevated taxiway edge light
LED Elevated obstacle light (low intensity)
LED Solar energy unserviceable area light

We hereby certify:

That we conducted an inspection, review and documental study of the characteristics of the above mentioned equipment based on the reports of tests carried by the laboratories:

Intertek and SQI - Shanghai Institute of Quality Inspection and Technical Research,

as Certified National Certification Body who carried out testing according to the IECEE CB Scheme for the Scope as listed in the relevant part of the IECEE Web Site at www.iecee.org.

On the base of all the foregoing, and in view of the results obtained; we confirm that: the elevated lights model **EOL-TE-LED**, **EOL-OB-LED**, **EOL-IA-LED** above referenced, manufactured by Airsafe Airport Equipment Co.Ltd., designed for airfield ground lighting applications,

FULFIL SATISFACTORILY

the demands and requirements of the above mentioned standards and of technical provisions of AENA referred in the present document, and specifically the specifications of the UNE-IEC/TS 61827 and AENA PPT 017 -04/12.

Test	Elevated lights	Result
	Type	It fulfils
<u>a. Dimensional test</u>	6.2	Satisfactory
<u>b. Test Environmental</u>		
High temperature	6.3.1.1	Satisfactory
Low temperature	6.3.1.2.2	Satisfactory
Thermal shock	6.3.2.2	Satisfactory
Corrosion (saline sprayed)	6.3.3.2	Satisfactory
Electromagnetic compatibility	6.3.6.	Satisfactory
Moisture	6.3.4.	Satisfactory
<u>c. Test Structural</u>		
Jet blast	6.4.2.1	Satisfactory
Frangibility	6.4.2.2	Satisfactory

Certificate n°08/X29/1/6346743-1001-11, rev.1

Page 1/3

This certificate cancels and replaces the certificate with number 08/X29/1/6346743-1001-11



E C A

d. Test Electrical Dielectric rigidity Creepage and clearance Resistance of isolation Electrical shock	6.5.1 6.5.2 6.5.3 6.5.4	Satisfactory Satisfactory Satisfactory Satisfactory
e. Functional test Photometry Chromaticity	6.6.1.1 6.6.2	Satisfactory Satisfactory
f. Endurance Test Accelerated life Test of useful rated life of LED's (10 lights)	6.7.1.2 6.7.2	Satisfactory Satisfactory

As well as the requirements listed to in ICAO Annex 14, Volume I, detailed below:

Elevated lights	Test	Test	Result It fulfils
	Photometry	Chromaticity	
EOL-TE-LED	Sec. 5.3.18.8	Figure A1-1 -Appendix 1-	Satisfactory
EOL-OB-LED	Table 6-1 Type A	Figure A1-1b -Appendix 1-	Satisfactory
EOL-IA-LED	Table 6-1 Type A	Figure A1-1b -Appendix 1-	Satisfactory

As well as the requirements listed to in Annex A of the Technical Specification Sheets of Aena, specific for lights that employ LED technology, detailed below:

Essay	Elevated lights	Result It fulfils
	Type	
a. Low Temperature	A.3.1.1	Satisfactory
b. Electromagnetic compatibility. Immunity to the Perturbations	A.3.1.2	Satisfactory
c. Intensity ratio	A.3.1.3	Satisfactory
d. High Temperature	A.3.1.4	Satisfactory
e. Electrical parameters	A.3.1.5	Satisfactory
f. Faults Monitoring System	A.3.1.6	Satisfactory
g. Optional antifreeze	A.3.1.7	Satisfactory
h. Accelerated life	A.3.1.8	Satisfactory
i. Useful rated life of LED	A.3.1.9	Satisfactory
j. Test of Life of the Sources of Light	A.3.1.9.1	Satisfactory
k. Test of Colour Maintenance of the Sources of Light	A.3.1.9.2	Satisfactory



E C A

I. Flicker	A.3.1.10	Satisfactory
m. Photobiological Safety	A.3.1.11	Satisfactory

And for the record for the appropriate purposes we issue and sign this Certification in Barcelona, on December 11 of 2017.

Inspector Bureau Veritas
Laura Arcas

