

■ RBCL-M-LED

■ LED Rotating Aeronautical Beacon

Compliance with Standards

CAAC: AC-137-CA-2015-11
 CAAC: MH 5001
 ICAO: Annex 14, Volume 1
 FAA: AC 150/5345-12
 NATO: STANG 3346

Application/Use

Beacon light at heliports and civil airports

Features

- Chromaticities and luminance in accordance with the provisions of ICAO Annex 14
- Constant LED lighting, featured by long working life, energy conservation, maintenance-free, which brings enormous economic benefits to customers
- Strict LED color management to ensure premium color consistency
- Standard driving motor achieves high strength, long service life and low noise, with 20 to 30 flashes per minute
- Modular design of LED driver circuits, convenient for maintenance
- Driver circuit integrated with surge protection function and over-heat protection module to enhance reliability
- EMI complies with FAA requirements, certified to FCC Part15 Class A standard
- Compact structure and attractive appearance, with small windward area, which can resist to up to 160 km/hr wind
- Main body with anti-corrosion surface, all fasteners made of stainless steel, suitable for harsh environment application



Ordering Information

RBCL-M-LED-XX/XXX

Type _____
 RBCL-M=Rotating Beacon Light
 Medium intensity

Illuminant _____
 LED = LED particle

Beam Color _____
 CY = Clear and Yellow
 CG = Clear and Green
 CYG = Clear, Yellow and Green

* Please provide detailed installation info while ordering, parts and accessories should be ordered separately specific with order no.

Construction

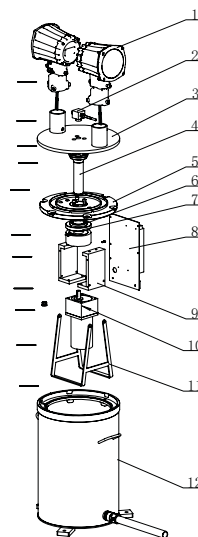

1. Lamp head
2. Adapter
3. Turntable
4. Main shaft
5. Flange plate
6. Bearing assembly
7. Slip ring
8. Electrical components assembly
9. Hanging rack
10. Electric machinery
11. Bracket
12. Box body

■ RBCL-M-LED

■ LED Rotating Aeronautical Beacon

Technical Parameter

Environment temperature: -40° to +55°
 Power supply: 200VA to 240VA 50/60Hz
 Total power: 165W
 Flashing rate: 25 to 37.5 F/min
 Torque of drive motor: 40N.m
 Light source: LED light source
 2×12×3W

Dimensions

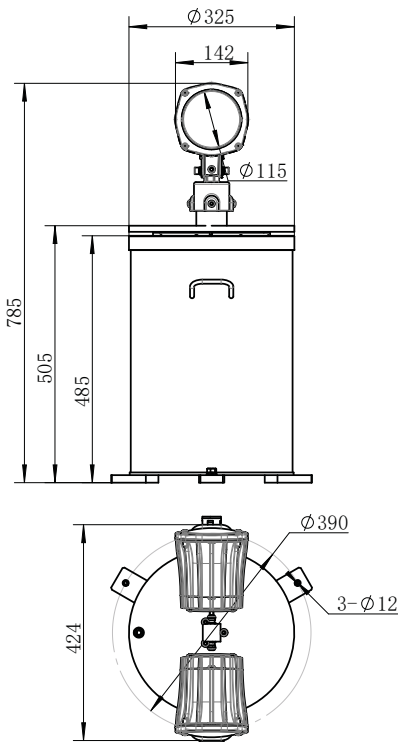

Accessories

Stuc.No	Accessories	Order Number	Notes
1	lamp head	62350-C/62350-G/62350-Y	C: white/G: green/Y: yellow
2	Adapter	46423/46427	For two / three lamp caps
3	Turntable	946411/46411-3	For two / three lamp caps
4	Main shaft	46409	
5	Flange Plate	924534	
6	Bearing assy	946410	
7	Slip ring	046983	
8	Electrical components assy	946412	
9	Hanging rack	46413	
10	Electric machinery	046877	
11	Bracket	46551	
12	Box body	46502	