



- TCLM-08
- Taxiway Centerline Light (Type I, 8-inch)

Compliance with Standards

- CAAC: AC-137-CA-2015-03
- SAC: GB/T 7256
- ICAO: Annex 14, Volume 1
- IEC: TS 61827
- FAA: AC 150/5345-46
- NATO: STANAG 3316

Application/Use

Taxiway centerline light

Features

- Proprietary prism structural design and manufacturing process to ensure excellent optical performance
- Self-alignment optical component without need of recalibration when replacing bulb as well as optical components
- Upper cover with flat out-light surface to prevent from water buildup and ensure high luminous efficiency
- Upper cover with equal-strength design and forging craft, which has premium mechanical and barrier capacity, and shock resistance ability
- Smooth and sleek upper cover to prevent from damaging aircraft tires
Lighting fixture made of highly conductive aluminum alloy, which ensures good heat dispersion
- Bulb Fixed mount suspension design to effectively prolong bulb's lifetime
- Main structure made of corrosion-resistant aluminum alloy with special special anodic oxidation treatment, all fasteners are made of stainless steel, suitable for harsh environment application
- High-precision parts and components machining to ensure all dimensional quality and precision
- IP68-grade, that can withstand inner pressure of up to 138kpa or water pressure generated from aircrafts' impact on the optical window
- Optimized module design, parts could be used for type I halogen in-pavement light fixtures, can reduce quantity requirement for spare parts

Ordering Information

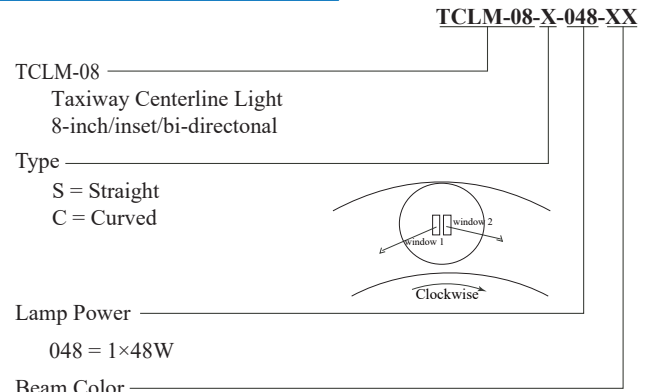

- GG = both windows are green
- YY = both windows are yellow
- GY = window 1 is green; window 2 is yellow
- YG = window 1 is yellow; window 2 is green
- YB = window 1 is yellow; window 2 is blank
- GB = window 1 is green; window 2 is blank
- BY = window 1 is blank; window 2 is yellow
- BG = window 1 is blank; window 2 is green

* Please provide detailed installation info while ordering, spare parts and accessories should be separately ordered with specific order no.

Installation

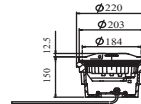

Fig 1. On 8" shallow base

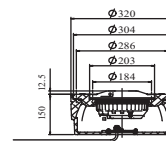

Fig 2. On 12" shallow base w/ 12"/8" adapter ring

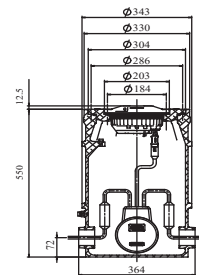
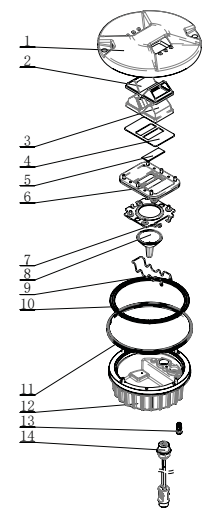

Fig 3. On 12" deep base w/ 12"/8" adapter ring

* Please find detailed information in installation manual

Structure

1. upper cover
2. prism gasket sleeve
3. prism
4. prism gasket
5. filter
6. prism pressing bracket
7. lamp holder
8. lamp
9. pressure spring for lamp
10. light body gasket
11. lighting fixture gasket
12. inner cover
13. valve
14. plug



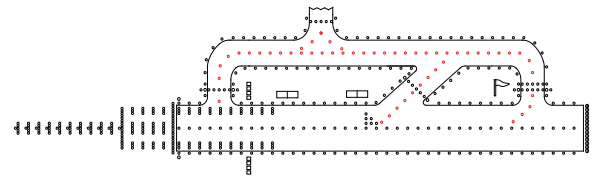

- TCLM-08
- Taxiway Centerline Light (Type I, 8-inch)

Light Source

Lamp: One 48W/6.6A reflector halogen lamps.

Photometric Data

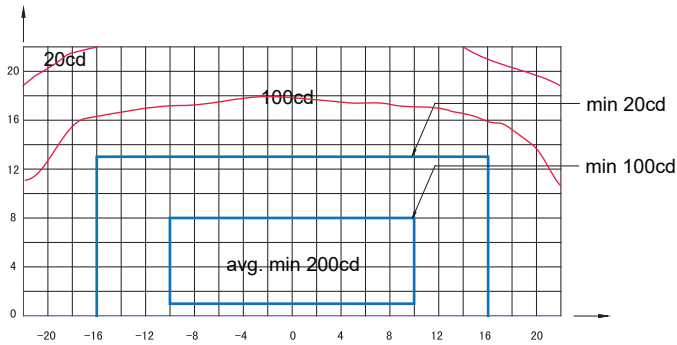

TCLM-08 (Green, for straight sections), ICAO Figure A2-12

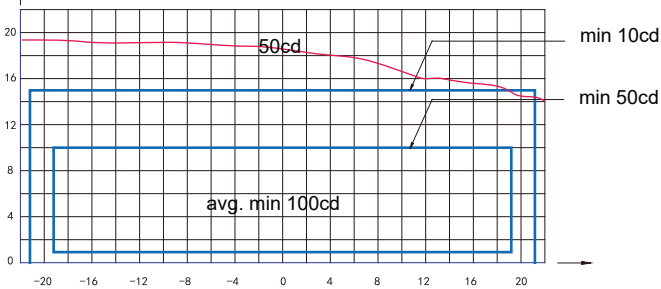

TCLM-08 (Green, for curved sections), ICAO Figure A2-14

Application		Main beam		Color	Required min avg. cd	Actual avg. cd
		H	V			
TCLM-08-S	ICAO Figure A2-12	±10°	1° to 8°	green	200	365
				yellow	200	458
	ICAO Figure A2-13/ FAA L-852C	±3.5°	1° to 8°	green	200	440
				yellow	200	526
TCLM-08-C	ICAO Figure A2-14/ FAA L-852K	±19.25° 15.75° toe-in	1° to 10°	green	100	238
				yellow	100	246

Packing Data

- 1 light w/o base Packing size: 210×210×130 mm³
- Unit net weight: 3.0 kg Gross weight: 3.1 kg
- 1 light w/ 8" shallow base Packing size: 240×240×180 mm³
- Unit net weight: 5.8 kg Gross weight: 6.0 kg

Spare parts

Struc No.	Part Name	Order No.	Description
2	Prism Gasket Sleeve	43109	Prism Gasket Sleeve Type B (unidirectional)
		43106	Prism Gasket Sleeve Type B (bidirectional)
3	Prism	31136	Prism H29 - Left toe-in
		31137	Prism H29 - Right toe-in
		31135	Prism H29 - Straight
4	Prism Gasket	43312	Prism Gasket (88×56)
5	Filter	31324-G	Filter-Green (46×17)
		31324-Y	Filter-Yellow (46×17)
6	Prism Pressing Bracket	43221	Prism Pressing Bracket (104×81)
8	Lamp	L64337	Halogen Lamp, 48W/6.6A
9	Lamp Pressure Spring	44209	Pressure Spring (37)
10	Light Body Gasket	41141	"O" Ring Seal (228.27×2.62)
11	Light Fixture Gasket	41107	Seal Belt (standard)
13	Valve	941801	Valve Inside Assy
14	Plug	HT70603	Secondary Cable Connector - Style 6 Plug (including terminal block)

Accessories

Sn	Order No.	Description
1	SB-08	8" Shallow Base Assy
2	SB-12	12" Shallow Base Assy
3	DB-12	12" Deep Base Assy
4	AR-12/08	12"-8" Adapter Ring Assy
5	951101	8" Lamp Holder
6	ITF-065-066	65W Isolation Transformer
7	REC7	Secondary Cable Receptacle Style 7

TCLM-08
2
2